

Mill Street Cut curb + gutter ADA Sidewalk

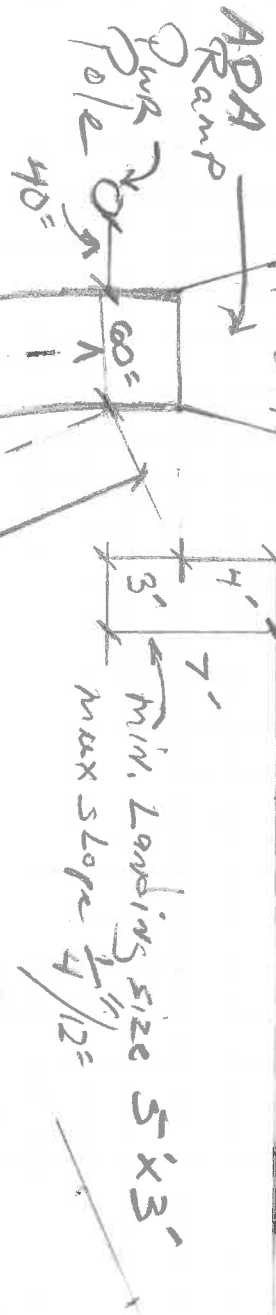

Slope of walk
MAX. 1"/12"

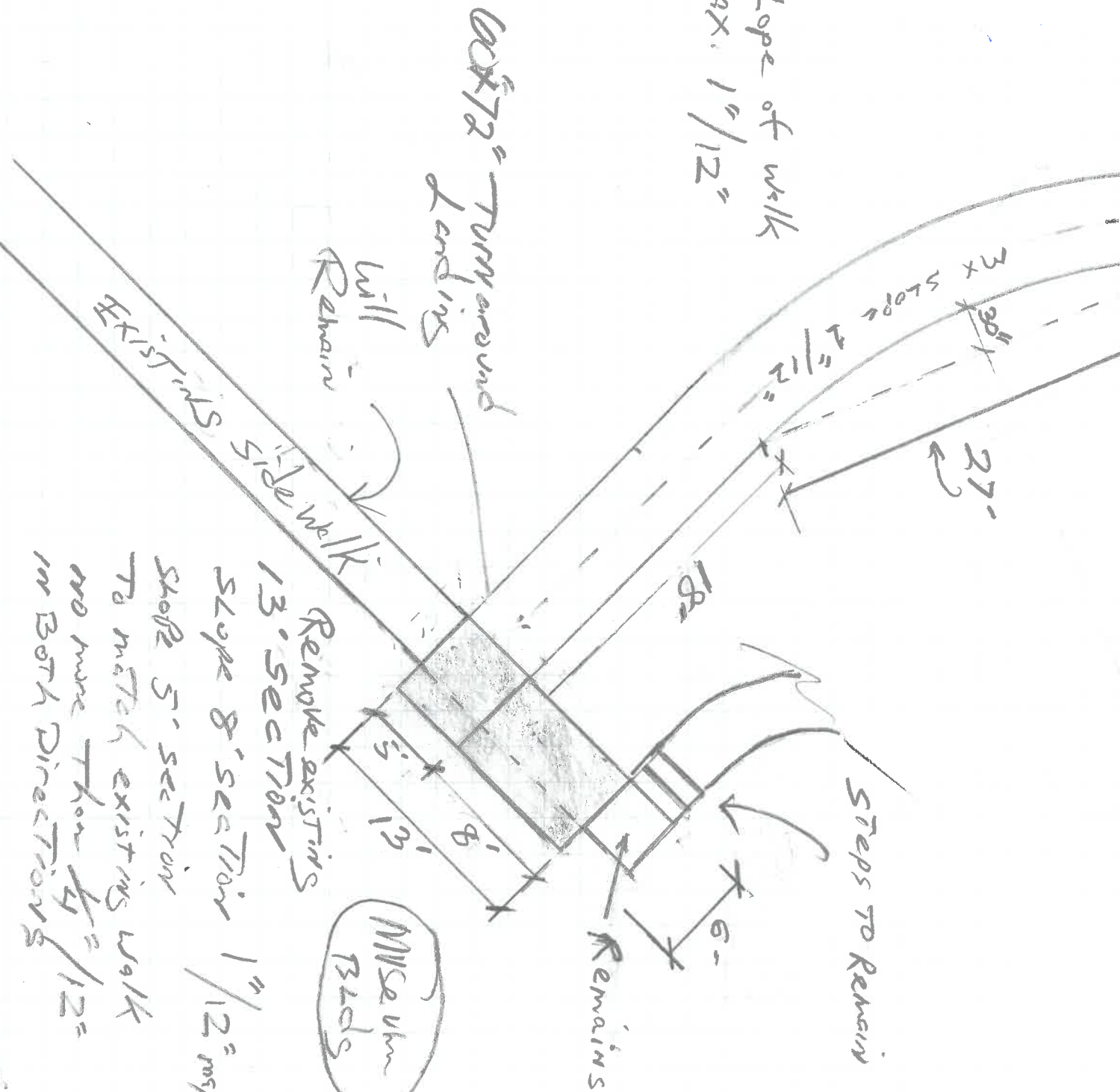

NOTE: Current Slope of 13' section is 8"
Recommended Slope 8' section - 7"
@ New walk: 5' section - 1"

Elevation View

13'

Existing walk

APPROX. 3/8 P.F.
8" slope

walk way

Slope 7"

8'

Landings

Slope 1"

5'

New walkway
section

8"

Match height here

